



TOWN OF WEBSTER

BUILDING PERMIT APPLICATION

Office (585) 872-7036 • Fax (585) 872-4437 • buildingdept@ci.webster.ny.us
1000 Ridge Road, Webster NY 14580

OFFICE USE
BP# _____

Applicant/Contact Person: Check if applicant is property owner

Name: _____ Address: _____

Phone: _____ E-mail: _____

Property Owner Information:

Name: _____ Phone: _____

E-mail: _____ Cell Phone: _____

Contractor: Check if not applicable (CE-200 will be required)

Name: _____ Address: _____

Phone: _____ E-mail: _____

Job Site Address: _____

Description of Work: SURVEY MAP TO SCALE SHOWING LOCATION OF WORK ON PROPERTY IS REQUIRED

Construction Cost: _____ **Zoning Board Approval:** Yes / No / Unknown
Planning Board Approval: Yes / No / Unknown

Note: Acceptance does not relieve the agent, architect, builder, engineer or owner from complying with any of the provisions of the NYS building codes, energy codes, SEQRA Act, local zoning etc., whether stated, implied or omitted in the plans and specifications submitted for the building permit.

By the signature below, on behalf of the applicant or owner, I hereby authorize representatives from the Town of Webster to enter the above referenced property, during normal hours, for the purpose of conducting inspections of the proposed construction/activity, as required by applicable law, rules, regulations ordinances and orders.

(Signature of Property Owner or Agent for Property Owner) Date

FOR OFFICE USE ONLY:

Lot Information: Front: _____ Left: _____ Right: _____ Rear: _____ Zoning: _____

Setbacks: Front: _____ Sides: _____ Rear: _____

Inspections Required:	
<input type="checkbox"/> Footing	<input type="checkbox"/> Rough Framing
<input type="checkbox"/> Foundation	<input type="checkbox"/> Rough Plumbing
<input type="checkbox"/> Insulation	<input type="checkbox"/> Under Slab Plumbing
<input type="checkbox"/> Final C/O	<input type="checkbox"/> Electrical Inspection
<input type="checkbox"/> Final C/C	<input type="checkbox"/> Other: _____

Approved



TOWN OF WEBSTER

Submission Requirements

Office (585) 872-7036 • Fax (585) 872-4437 • buildingdept@ci.webster.ny.us

- All submissions will be reviewed by the Building Inspector and Department of Community Development (if necessary) for any proposed construction project.
 - All Applicants must submit proof of the following: Liability Insurance & Workers' Compensation Insurance, unless a Certificate of Attestation of exemption from the NYS Workers Compensation Board (CE-200) is submitted waving Workers' Compensation.
 - All Certificates are required to list The Town of Webster, 1000 Ridge Rd, Webster, NY 14580 as certificate holder.
1. **New Homes:**
 - a. A completed building permit application
 - b. Two (2) sets of printed plans; One (1) set must be stamped by a licensed architect/engineer and will remain in the Building department, plus one additional copy of plans to be submitted in pdf format
 - c. Energy Conservation Construction Code (RES-check Comp. Certificate/or other approved method)
 - d. Manual "J"/ Heat Calculations, Plot/Tape Map
 2. **Additions to Residential Properties:**
 - a. A completed building permit application
 - e. Construction drawings (Two (2) sets of stamped Architectural drawings if construction is over \$20,000, plus one additional copy of plans to be submitted in pdf format)
 - b. Instrument Survey of the property showing location of construction project
 3. **Permits are also required for:** accessory structures, sheds, above & inground pools, decks, cabanas, gazebos, arbors, generators, finished areas such as basements or bonus rooms, egress windows or bitco doors, demolition of a building, tank removal etc. Also for all signs. Please call the office at (585) 872-7036 or visit the website at www.ci.webster.ny.us if you are unsure whether a permit is required for your project.

(the following information is not applicable to some of these items)

 - a. A completed building permit application
 - b. Decks require a copy of the construction drawings with footings (size/ depth), framing (size/ spans), and square footage indicated
 - c. An Instrument Survey of the property showing location of construction project
 - c. Interior renovations require a floor plan; finished basements will require an egress window to be installed that meets NYS Building Codes and must be shown on the plans
 4. **Fences & Sheds**
 - a. A completed building permit application
 - b. If applying for a shed, specifications of shed must accompany the permit application
 - c. An Instrument Survey of the property showing location of construction project
(must follow guidelines for installation of sheds & fence, see website for complete details)
 5. **Re-Roof**
 - a. A completed building permit application
 - b. Proof of Insurance, Liability & Workers' Compensation
 6. **Commercial: New Construction, Renovation & Additions**
 - a. A completed building permit application
 - b. Two (2) complete stamped sets of plans
 - c. Proof of Insurance, Liability & Workers' Compensation
 - d. Any necessary ComChecks, Water Usage, code reviews or other paperwork required after review

Typical Deck Drawing Information Needed

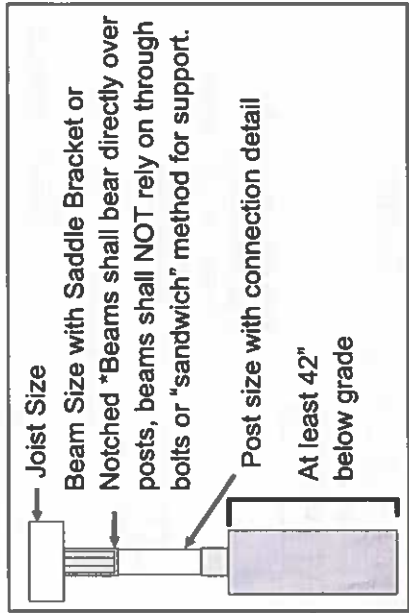

Total Width: _____

Joist Cantilever Length: _____

Post Locations

Joist Spacing: _____

Joist Size: 2 x _____ Feet
 Max Joist Span: _____ Feet
 (Longest span between beams)

Joist Span

Post Size: 6 x 6 4 x 4 Other: _____

Beam Span

Beam Size: 2 x _____ PLY: (Double) (Triple)
 Max Beam Span: _____ Feet
 (Longest span between posts)

Deck Is: (Attached to House) or (Freestanding)

Ledger Board Size: 2 x _____

Ledger Board Size with Flashing and Connection detail

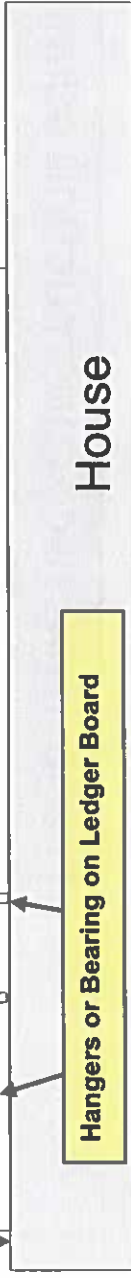

Hangers or Bearing on Ledger Board

House

Total Length: _____

RESIDENTIAL DECK CONSTRUCTION GUIDE

NOTCHED POST

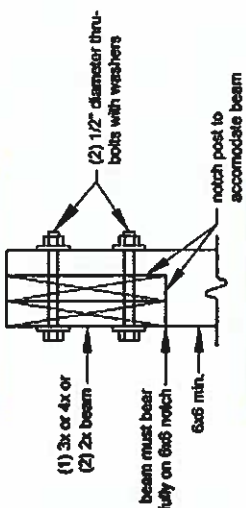

POST WITH CAP

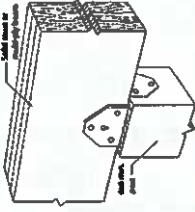

SANDWICH METHOD PROHIBITED

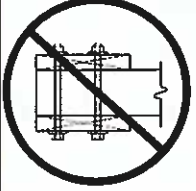

DECK JOIST SPAN CHART

Joist Size	Allowable Joist Span			Maximum Cantilever		
	Spacing of Deck Joists (Inches)	Spacing of Deck Joists With Cantilevers (Inches)	Spacing of Deck Joists With Cantilevers (Inches)	Spacing of Deck Joists (Inches)	Spacing of Deck Joists With Cantilevers (Inches)	Spacing of Deck Joists With Cantilevers (Inches)
2 x 6	12" o/c	16" o/c	24" o/c	12" o/c	16" o/c	24" o/c
2 x 8	9' 11"	9' 0"	7' 7"	1' 3"	1' 4"	1' 6"
2 x 10	13' 1"	11' 10"	9' 8"	2' 1"	2' 3"	2' 5"
2 x 12	16' 2"	14' 0"	11' 5"	3' 4"	3' 6"	2' 10"
	18' 0"	16' 6"	13' 6"	4' 6"	4' 2"	3' 4"

DECK BEAM SPAN CHART

Beam Size	Deck Joist Span Less Than or Equal To (Feet):						
	6'	8'	10'	12'	14'	16'	18'
2 - 2 x 6	6' 11"	5' 11"	5' 4"	4' 10"	4' 6"	4' 3"	4' 0"
2 - 2 x 8	8' 9"	7' 7"	6' 9"	6' 2"	5' 9"	5' 4"	5' 0"
2 - 2 x 10	10' 4"	9' 0"	8' 0"	7' 4"	6' 9"	6' 4"	6' 0"
2 - 2 x 12	12' 2"	10' 7"	9' 5"	8' 7"	8' 0"	7' 6"	7' 0"
3 - 2 x 8	10' 10"	9' 6"	8' 6"	7' 9"	7' 2"	6' 8"	6' 4"
3 - 2 x 10	13' 0"	11' 3"	10' 0"	9' 2"	8' 6"	7' 11"	7' 6"
3 - 2 x 12	15' 3"	13' 3"	11' 10"	10' 9"	10' 0"	9' 4"	8' 10"

RAILING/GUARD DETAIL

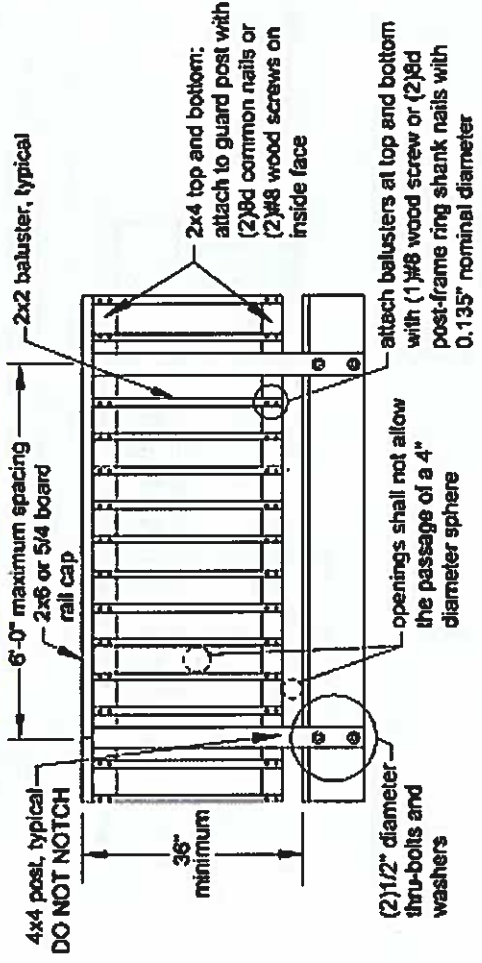

STAIR DETAIL

